



Vlier-LOCK Ball Locking Pins



Spec - Sheet



New for 2006 Vlier-LOCK quick release Pins. These Commercial grade pins are readily available and are offered in the most popular sizes at an economical cost. Your choice of either "T" handle, or button handle, these designs are perfect for manufacturing, medical, vehicle, marine, and many other applications

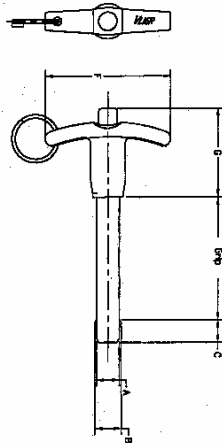

T-Handle w/
Stainless Steel
Pin

Vlier Part Number	Nom Ø	Grip Length (+ .020 / - .000)	A (+ .0000 / - .0015)	B (+ .005 / - .000)	C (+ .000 / - .030)	F (T-HANDLE)	G (T-HANDLE)
SVLP25CT05	0.25 (1/4)	0.50	0.2485	0.289	0.290	1.815	1.270
SVLP25CT10		1.00	0.2485	0.289	0.290	1.815	1.270
SVLP25CT15		1.50	0.2485	0.289	0.290	1.815	1.270
SVLP25CT20		2.00	0.2485	0.289	0.290	1.815	1.270
SVLP25CT25		2.50	0.2485	0.289	0.290	1.815	1.270
SVLP25CT30		3.00	0.2485	0.289	0.290	1.815	1.270
SVLP25CT35		3.50	0.2485	0.289	0.290	1.815	1.270
SVLP25CT40		4.00	0.2485	0.289	0.290	1.815	1.270
SVLP31CT05	0.31 (5/16)	0.50	0.311	0.375	0.330	1.815	1.270
SVLP31CT10		1.00	0.311	0.375	0.330	1.815	1.270
SVLP31CT15		1.50	0.311	0.375	0.330	1.815	1.270
SVLP31CT20		2.00	0.311	0.375	0.330	1.815	1.270
SVLP31CT25		2.50	0.311	0.375	0.330	1.815	1.270
SVLP31CT30		3.00	0.311	0.375	0.330	1.815	1.270
SVLP31CT35		3.50	0.311	0.375	0.330	1.815	1.270
SVLP31CT40		4.00	0.311	0.375	0.330	1.815	1.270
SVLP37CT05	0.37 (3/8)	0.50	0.3735	0.44	0.365	2.065	1.450
SVLP37CT10		1.00	0.3735	0.44	0.365	2.065	1.450
SVLP37CT15		1.50	0.3735	0.44	0.365	2.065	1.450
SVLP37CT20		2.00	0.3735	0.44	0.365	2.065	1.450
SVLP37CT25		2.50	0.3735	0.44	0.365	2.065	1.450
SVLP37CT30		3.00	0.3735	0.44	0.365	2.065	1.450
SVLP37CT35		3.50	0.3735	0.44	0.365	2.065	1.450
SVLP37CT40		4.00	0.3735	0.44	0.365	2.065	1.450
SVLP50CT05	0.50 (1/2)	0.50	0.4985	0.594	0.460	2.345	1.600
SVLP50CT10		1.00	0.4985	0.594	0.460	2.345	1.600
SVLP50CT15		1.50	0.4985	0.594	0.460	2.345	1.600
SVLP50CT20		2.00	0.4985	0.594	0.460	2.345	1.600
SVLP50CT25		2.50	0.4985	0.594	0.460	2.345	1.600
SVLP50CT30		3.00	0.4985	0.594	0.460	2.345	1.600
SVLP50CT35		3.50	0.4985	0.594	0.460	2.345	1.600
SVLP50CT40		4.00	0.4985	0.594	0.460	2.345	1.600
SVLP62CT05	0.62 (5/8)	0.50	0.6235	0.750	0.580	3.100	1.700
SVLP62CT10		1.00	0.6235	0.750	0.580	3.100	1.700
SVLP62CT15		1.50	0.6235	0.750	0.580	3.100	1.700
SVLP62CT20		2.00	0.6235	0.750	0.580	3.100	1.700
SVLP62CT25		2.50	0.6235	0.750	0.580	3.100	1.700
SVLP62CT30		3.00	0.6235	0.750	0.580	3.100	1.700
SVLP62CT35		3.50	0.6235	0.750	0.580	3.100	1.700
SVLP62CT40		4.00	0.6235	0.750	0.580	3.100	1.700

VLIER VLIER VLIER VLIER VLIER VLIER VLIER VLIER VLIER VLIER VLIER

Call your Authorized VLIER dealer or contact us at 800/821-1090
or visit us on the web at www.vlier.com





Vlier-LOCK Ball Locking Pins

Button Handle
w/ Stainless
Steel Pin

Spec - Sheet



SPECIAL FEATURES

- T-Handle & Button Handle
- L Handle Available Special Request
- Handles are black anodized Aluminum with brass push button
- Shank body is 300 Stainless Steel
- Low Cost & Available

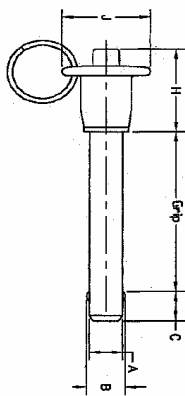
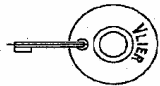

Vlier Part Number	Nom ø	Grip Length (+.020 / -.000)	A		B		C		H		J (BUTTON HANDLE)	
			(+.0000 / -.0015)	(+.0005 / -.000)	(+.000 / .030)	Button	MAX	MIN				
SVLP25CB05	0.25 (1/4)	0.50	0.2485	0.289	0.290	0.890	0.800	0.720				
SVLP25CB10		1.00	0.2485	0.289	0.290	0.890	0.800	0.720				
SVLP25CB15		1.50	0.2485	0.289	0.290	0.890	0.800	0.720				
SVLP25CB20		2.00	0.2485	0.289	0.290	0.890	0.800	0.720				
SVLP25CB25		2.50	0.2485	0.289	0.290	0.890	0.800	0.720				
SVLP25CB30		3.00	0.2485	0.289	0.290	0.890	0.800	0.720				
SVLP25CB35		3.50	0.2485	0.289	0.290	0.890	0.800	0.720				
SVLP25CB40		4.00	0.2485	0.289	0.290	0.890	0.800	0.720				
SVLP31CB05	0.31 (5/16)	0.50	0.311	0.375	0.330	0.930	1.135	0.810				
SVLP31CB10		1.00	0.311	0.375	0.330	0.930	1.135	0.810				
SVLP31CB15		1.50	0.311	0.375	0.330	0.930	1.135	0.810				
SVLP31CB20		2.00	0.311	0.375	0.330	0.930	1.135	0.810				
SVLP31CB25		2.50	0.311	0.375	0.330	0.930	1.135	0.810				
SVLP31CB30		3.00	0.311	0.375	0.330	0.930	1.135	0.810				
SVLP31CB35		3.50	0.311	0.375	0.330	0.930	1.135	0.810				
SVLP31CB40		4.00	0.311	0.375	0.330	0.930	1.135	0.810				
SVLP37CB05	0.37 (3/8)	0.50	0.3735	0.44	0.365	1.040	1.135	0.875				
SVLP37CB10		1.00	0.3735	0.44	0.365	1.040	1.135	0.875				
SVLP37CB15		1.50	0.3735	0.44	0.365	1.040	1.135	0.875				
SVLP37CB20		2.00	0.3735	0.44	0.365	1.040	1.135	0.875				
SVLP37CB25		2.50	0.3735	0.44	0.365	1.040	1.135	0.875				
SVLP37CB30		3.00	0.3735	0.44	0.365	1.040	1.135	0.875				
SVLP37CB35		3.50	0.3735	0.44	0.365	1.040	1.135	0.875				
SVLP37CB40		4.00	0.3735	0.44	0.365	1.040	1.135	0.875				
SVLP50CB05	0.50 (1/2)	0.50	0.4985	0.594	0.460	1.190	1.400	1.300				
SVLP50CB10		1.00	0.4985	0.594	0.460	1.190	1.400	1.300				
SVLP50CB15		1.50	0.4985	0.594	0.460	1.190	1.400	1.300				
SVLP50CB20		2.00	0.4985	0.594	0.460	1.190	1.400	1.300				
SVLP50CB25		2.50	0.4985	0.594	0.460	1.190	1.400	1.300				
SVLP50CB30		3.00	0.4985	0.594	0.460	1.190	1.400	1.300				
SVLP50CB35		3.50	0.4985	0.594	0.460	1.190	1.400	1.300				
SVLP50CB40		4.00	0.4985	0.594	0.460	1.190	1.400	1.300				
SVLP62CB05	0.62 (5/8)	0.50	0.6235	0.750	0.580	1.500	1.700	1.530				
SVLP62CB10		1.00	0.6235	0.750	0.580	1.500	1.700	1.530				
SVLP62CB15		1.50	0.6235	0.750	0.580	1.500	1.700	1.530				
SVLP62CB20		2.00	0.6235	0.750	0.580	1.500	1.700	1.530				
SVLP62CB25		2.50	0.6235	0.750	0.580	1.500	1.700	1.530				
SVLP62CB30		3.00	0.6235	0.750	0.580	1.500	1.700	1.530				
SVLP62CB35		3.50	0.6235	0.750	0.580	1.500	1.700	1.530				
SVLP62CB40		4.00	0.6235	0.750	0.580	1.500	1.700	1.530				

Performance Specifications

SHAFT DIAMETER, INCH	DOUBLE SHEAR STRENGTH, lbf	PULL OUT STRENGTH, lbf	RECEIVING HOLE DIAMETER, INCH	
			MIN	MAX
1/4	7,000	180	.250	.252
5/16	9,500	400	.312	.314
3/8	12,500	450	.375	.377
1/2	22,000	900	.500	.502
5/8	25,000	1,500	.625	.627

VLIER VLIER VLIER VLIER VLIER VLIER VLIER VLIER VLIER VLIER VLIER VLIER



Call your Authorized VLIER dealer or contact us at 800/821-1090
or visit us on the web at www.vlier.com